



GRETZ ELEMENTARY SCHOOL

TEL AVIV – YAFO



PROPOSAL FOR THE ESTABLISHMENT OF A NEW LIBRARY AND RESOURCE CENTER



BACKGROUND

The Gretz Elementary School was established in 1934 and named after the historian Heinrich Gretz who wrote about the people of Israel. The school is located in the center of Tel Aviv, an area populated by young middleclass families as well as single parent families and new immigrants.

430 pupils study in 16 homeroom classes. 100 of the pupils are gifted children arriving from all areas of the city. The other 330 pupils live within the school's neighborhood.

10% of the pupils are diagnosed as learning disabled or as needing learning or emotional support. A high percentage of the pupils reach the required scholastic level and above, while a small percentage is below average.

There is no community center in the vicinity of the school to occupy the children so the school has taken upon itself to offer a lively range of after school activities and extracurricular classes until the evening hours. As a result, parents and children can be found on school grounds hours after the regular school day has ended.

In addition, there is an active parent's association which meets every month to discuss issues pertaining to the school.

The curriculum for the gifted classes is based on the regular curriculum with additional studies to widen and deepen the children's understanding of the various subjects. They are taught using various and up to date teaching methods. The enrichment classes are held within and outside of the school.



IMPORTANT FACTORS

- The school has been recognized as a “green school” emphasizing serious thought and study on protecting the environment.
- The school operates a program – "The Intergenerational Connection" – where 6th grade pupils teach the elderly computer skills and learn from the adults about their lives and about the history of Israel.
- The school has a language room which provides a challenging and unique learning environment by focusing on culture and language: English begins in 1st grade, Arabic in 3rd grade, Spanish in 5th grade and French can be chosen in 6th grade.
- It is also possible to learn a musical instrument under the auspices of the Jaffa Music Center. There is also an active children's orchestra.
- An after school center operates at the end of the school day beginning from 1pm to 5:30 pm. There are approximately 60 children in the center, mainly 1st to 3rd graders.



THE SCHOOL LIBRARY AS A RESOURCE CENTER

One of the school's main goals is to nurture academic excellence among the pupils and help them reach their individual potential. In order to fulfill this goal it is of utmost importance to upgrade the library and turn it into the “center” of the school.

The library will become the center of educational and learning activities, a communications center with computers that encourages interactive learning.

It should be noted that there is no library near the school that can be used by the pupils in the afternoon hours.

Also, since the school specializes in teaching gifted pupils, it is of great importance that there is an updated library, accessorized and equipped with the best literature relevant to the target community of the school, children and parents alike.

THE PLAN

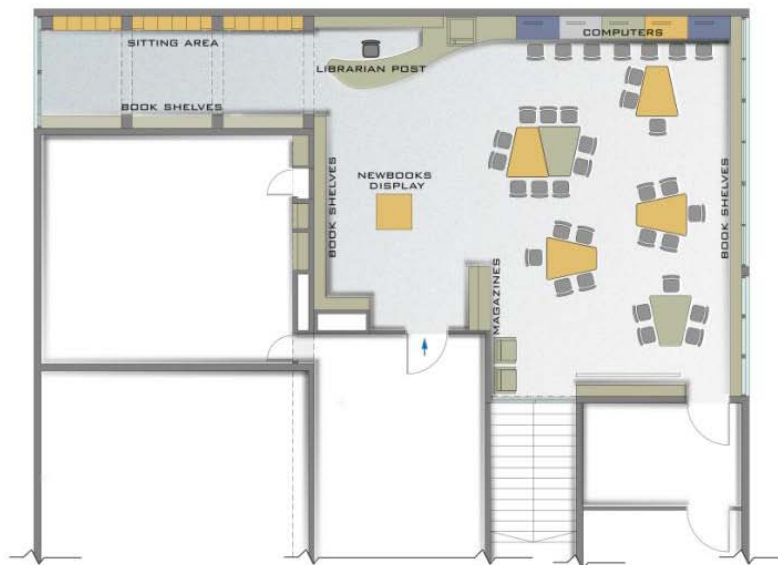

New plans have been prepared by Architect Eli Eliakim.

The Library and resource center will be expanded to 1,400 square feet and will include:

- Reading hall
- Computer area

- Periodicals and books display
- Librarian desk
- Periodicals recreation area
- Shelves for 4,500 books (2,700 reading and 1,800 reference books)
- Bag storage lockers
- Area for meetings and screenings
- Projector from the ceiling and screen

THE COST

The cost to establish the library and resource center is: \$ 380,000.

The Municipality of Tel Aviv Jaffa will match 50% of the total cost

REQUESTED DONATION: \$ 190,000.

The library and resource center will be named per the donor's request.

To learn more about the Tel Aviv Foundation, visit

www.telavivfoundation.org

